

## ПЦ-2416

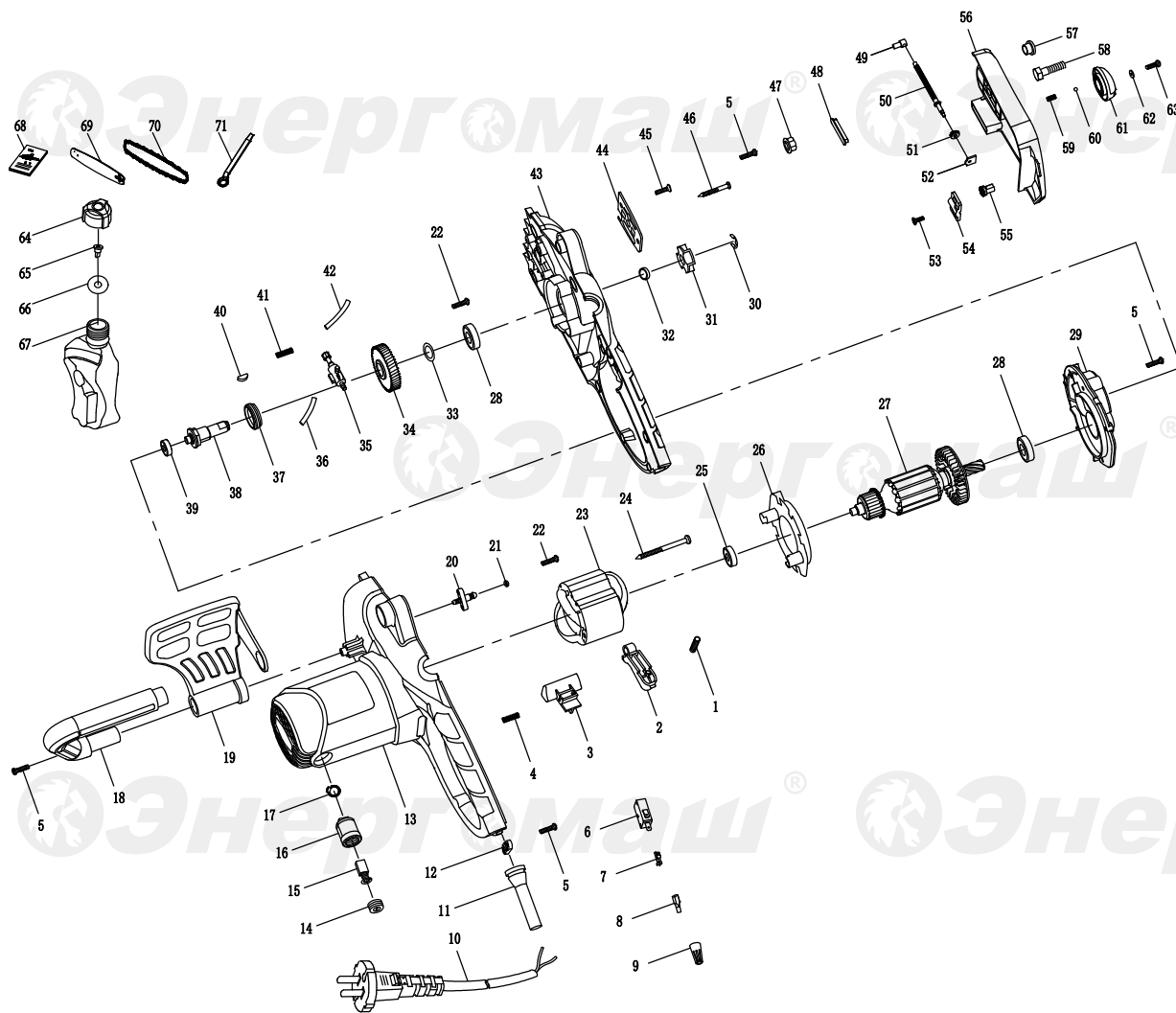

NO	DESCRIPTION	NO	DESCRIPTION
1	TRIGGER SPRING	37	WORM
2	TRIGGER	38	OUTPUT SHAFT
3	TRIGGER LOCK	39	BEARING 698
4	TRIGGER LOCK SPRING	40	WOODRUFF KEY
5	SCEW	41	OIL PUMP SPRING
6	MICROSWITCH	42	OIL PUMP OUTLET PIPE
7	STRIGHT PLUG SPRING	43	RIGHT HOUSING
8	TERMINALS JACKET-SMALL	44	GUIDE BAR PLATE
9	TERMINALS CAP	45	SCREW
10	CABLE	46	SCREW
11	CABLE SHIELD	47	NUT
12	CABLE PLATE	48	SPROCKET COVER GASKET
13	LEFT HOUSING	49	TENSIONER PIN
14	BRUSH COVER	50	TENSIONER BOLT
15	CARBON BRUSH	51	TENSIONER PASSIVE GEAR
16	BRUSH HOLDER	52	TENSIONER LOCATION PIN
17	STATOR TENSION SPRING	53	SCREW
18	FRONT HANDLE	54	TENSIONER PLATE
19	FRONT HANDLE GUARD	55	TENSIONER DRIVING GEAR
20	OIL NOZZLE	56	SPROCKET COVER
21	OIL NOZZLE SEAL	57	SPROCKET COVER SLEEVE
22	SCREW	58	HEXAGON BOLT
23	STATOR	59	KNOB SPRING
24	SCREW	60	STEEL BALL 4.5
25	BEARING 608	61	TENSIONER KNOB
26	FAN COVER	62	BIG WASHER
27	ROTOR	63	SCREW
28	BEARING 6001	64	OIL CAP
29	GEAR BOX	65	OIL CAP BALANCER
30	CIRCLIP	66	OIL CAP SEAL
31	DRIVE SPROCKET	67	OIL BOTTLE
32	SPROCKET WASHER	68	MANUAL
33	GEAR SPACE SHIM	69	GUIDE BAR
34	BIGL GEAR	70	CHAIN
35	OIL PUMP	71	SPANNER
36	OIL PUMP INLET PIPE		